

EGRESS PLAN  
LEGEND

- 1-HOUR RATED WALL
- 2-HOUR RATED WALL
- TRAVEL DISTANCE
- EXIT SIGN WITH BATTERY PACK
- SURFACE MOUNTED TYPE ABC FIRE EXTINGUISHER & CABINET. EXTINGUISHERS SHALL BE CURRENTLY DATED AND TAGGED BY LICENSED FIRE EQUIPMENT COMPANY, AND LOCATED NOT FURTHER THAN 75 FEET OF TRAVEL DISTANCE TO AN EXTINGUISHER
- SURFACE MOUNTED TYPE ABC FIRE EXTINGUISHER INSTALLED ON SUPPLIED BRACKET. EXTINGUISHERS SHALL BE CURRENTLY DATED AND TAGGED BY LICENSED FIRE EQUIPMENT COMPANY, AND LOCATED NOT FURTHER THAN 75 FEET OF TRAVEL DISTANCE TO AN EXTINGUISHER

EGRESS NOTES

- COORDINATE FIRE ALARM DEVICES AND PANELS WITH ELECTRICAL DRAWINGS
  - REFER TO FIRE PROTECTION DRAWINGS FOR SPRINKLER HEAD LOCATIONS
  - REFER TO ELECTRICAL DRAWINGS FOR FIRE ALARM DEVICE LOCATIONS
  - REFER TO ELECTRICAL DRAWINGS FOR EMERGENCY LIGHT LOCATIONS
  - ORDINARY HAZARD OF CONTENTS (NFPA 38.1.5.1)
  - A FACTOR OF 0.2 INCHES OF WIDTH PER OCCUPANT HAS BEEN USED TO CALCULATE MINIMUM DOOR AND CORRIDOR EGRESS CAPACITY
  - A FACTOR OF .3 INCHES OF WIDTH PER OCCUPANT HAS BEEN USED TO CALCULATE MINIMUM CLEAR WIDTH OF STAIRWAY EGRESS CAPACITY
- AUTOMATIC EXTERNAL DEFIBRILLATORS (AED) AND STOP THE BLEED KITS (SBK) SHALL BE INSTALLED AS DEFINED IN NFPA 101, LIFE SAFETY CODE, ON EVERY OTHER FLOOR BEGINNING ON THE FIRST FLOOR. THE AED AND SBK SHALL BE PLACED NEAR THE ELEVATOR(S) BEGINNING IN THE FIRST-FLOOR LOBBY (FIRST FLOOR, THIRD FLOOR, FIFTH FLOOR, ETC.) REFER TO BROWARD FIRE CODE AMENDMENTS SECTION F-121 FOR ADDITIONAL INFORMATION FOR LOCATION, MOUNTING, INVENTORY, TRAINING, AND INSPECTION OF REQUIRED EQUIPMENT.

REVISIONS

DATE:	COMM:
01/12/24	22019

580 BRINY AVE.

580 BRINY AVE.  
POMPAN0 BEACH, FL

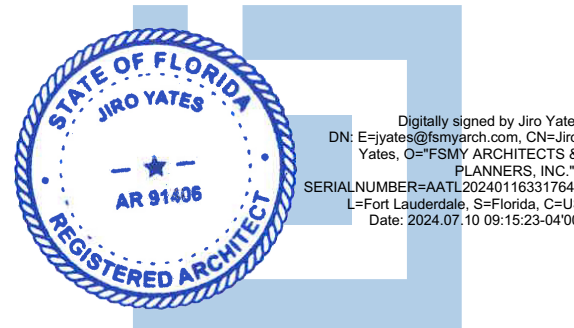

LEVEL 09  
FLOOR PLAN  
SITE PLAN APPROVAL

A-106

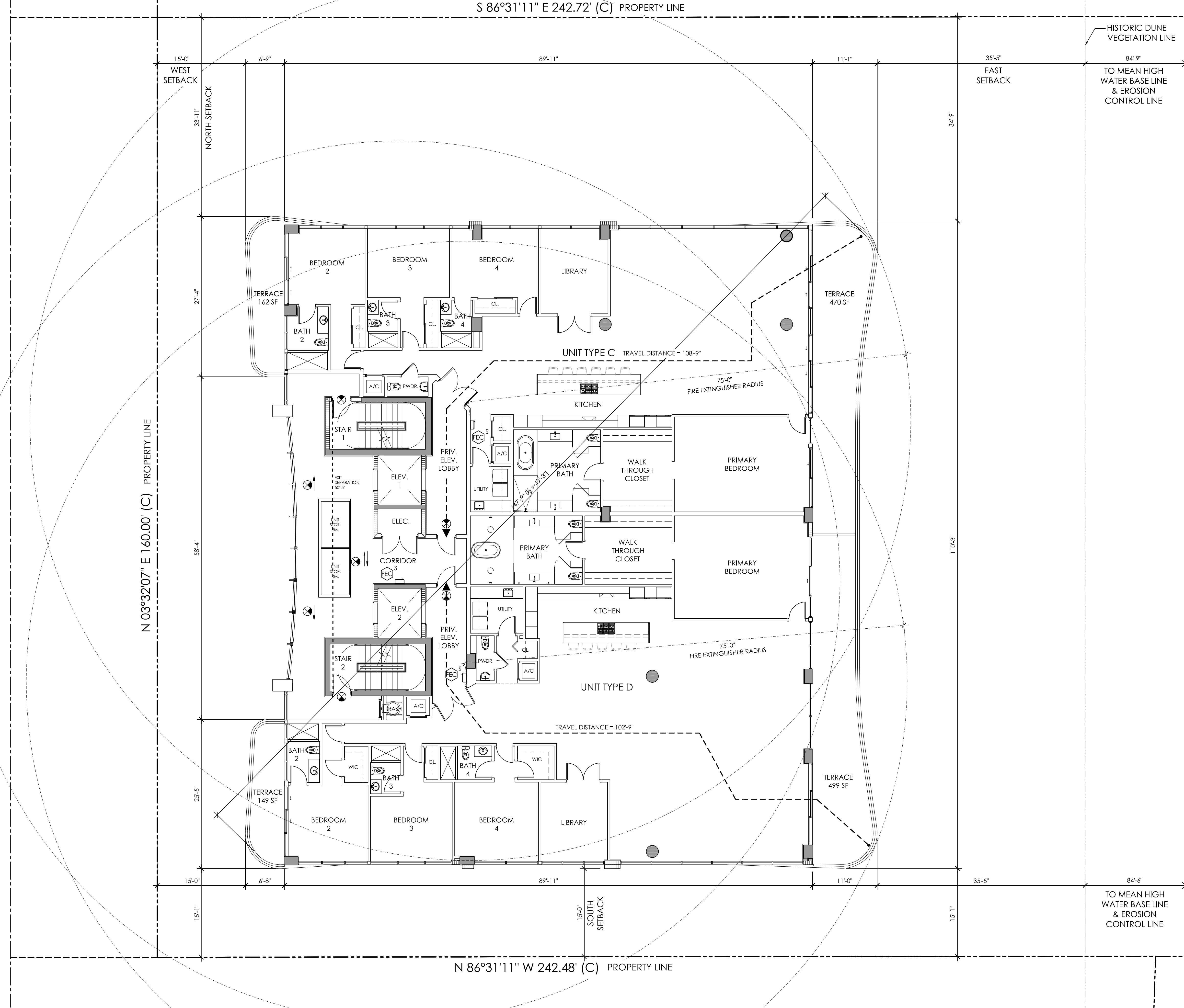

LEVEL 09 - FLOOR PLAN  
SCALE: 1/8" = 1'-0"